





 Alaska & North America  
58° 39' N 136° 54' W

# Exploring Alaska's Coastal Wilderness

Do more than just see Alaska—be an active participant in all that it has to offer. Voyage into majestic fjords, come face to face with glaciers, and kayak along the coast in search of marine life. Learn about whale behavior and watch for breaching and spy-hopping humpbacks and orcas. Enjoy a full day immersed in the beauty of Glacier Bay National Park.

**Note:** Please contact Lindblad Expeditions directly with all trip inquiries and to make a reservation. Their travel consultants are eager to take your call and answer your questions.  
**(833) 985-1261 / [groups@expeditions.com](mailto:groups@expeditions.com)**

From  
**\$ 6,286** / per person  
Does not include flights

 <b>DATES</b> May 25 - June 1, 2025	 <b>DURATION</b> 8 Days
 <b>SHIP</b> <i>National Geographic Quest</i>	
 <b>STARTS AT</b> Sitka, Alaska	  <b>ENDS AT</b> Juneau, Alaska

Please review the [Essential Eligibility Criteria](#) for hiking activities on this voyage.

The [National Park Service](#) and the Department of the Interior authorize this institution to serve the public in Glacier Bay National Park and Preserve.

This institution is an [equal opportunity provider](#).

## Highlights

- ★ Join MIT Professor Andrew Babbin - a field-going oceanographer, biogeochemist, and climate scientist
- ★ Hike through lush forests and muskegs, kayak into secluded inlets, and cruise by Zodiac among electric blue icebergs and curious wildlife
- ★ Encounter iconic Alaska wildlife such as humpback whales, bears, otters, and bald eagles
- ★ Witness calving glaciers and search for puffins and mountain goats on a full-day exploration of Glacier Bay National Park and Preserve
- ★ Meet our conservation partners from the Alaska Whale Foundation (schedules permitting) and learn how you can contribute to their research throughout your voyage



## Day by day

### ■ DAY 1

#### Sitka, Alaska / Embark Ship

Arrive in Sitka, Alaska, situated on the western coast of Baranof Island and overlooking the Pacific Ocean. Schedules permitting, walk among Tlingit and Haida totem poles at Sitka National Historic Park and visit the Alaska Raptor Center for an up-close look at Alaska's birds of prey. Embark this evening in time for cocktails and an introduction to the staff and crew.

*Please note: Itinerary stops and sequence subject to modification.*

**Arrival Time:** Arrive by 2:00 p.m. local time.

**Arrival City:** Sitka

Meals included: dinner

### ◇ DAY 2

#### Southeast Alaska's Islands, Bays & Fjords

*Our Forest Service Special Use Permit for Tongass National Forest enables guests to hike and kayak in wild and remote areas of Southeast Alaska.*

Today, nature is our guide as we set forth with the flexibility to take advantage of wildlife and weather conditions. We may stop at an isolated beach to take a closer look at tide pools, beachcomb, and hike stunning forest trails. Keep an eye out for old bear tracks worn into the soil as you move from forest to meadow. Sightings of bald eagles are common. If conditions permit, we will do some kayaking, always watching for marine and terrestrial life.

Meals included: breakfast, lunch, dinner

### ◇ DAY 3

#### Icy Strait and the Inian Islands

Explore among the Inian Islands, a busy feeding ground for myriad wildlife species including Steller sea lions and sea otters. We will search for marine mammals in the nutrient-rich waters of Icy Strait and choose the perfect spot around Chichagof Island to hike where sightings of bald eagles are common.

Meals included: breakfast, lunch, dinner

### ◇ DAY 4

#### Glacier Bay National Park

We spend the entire day amid the coves, fjords, tidewater glaciers and majestic mountains of Glacier Bay National Park. Witness glaciers that end abruptly at the water's edge and observe them calving, when tons of ice separate and crash into the water accompanied by a thunderous sound. Mountain goats scaling the peaks as well as harbor seals, Steller sea lions and puffins are some of the creatures we may observe. A visit to Tidal Inlet may bring the sight of brown bears lumbering up the hillside.

Meals included: breakfast, lunch, dinner

### ◇ DAY 5

#### Frederick Sound and Chatham Strait

These waters are prime areas for both orca and humpback whales. With luck, guests may observe their fascinating behavior—breaching, tail-slapping and variations on feeding—as we fill the deck and listen to the play-by-play from our expert naturalists. We will explore spectacular bays and inlets, following bear trails and salmon streams. Once ashore, we have the opportunity to walk along a quiet forest trail. The still waters are excellent for kayaking, offering another option for up-close exploration.

Meals included: lunch, dinner, breakfast

◇ DAY 6

### Petersburg

Visit the small, true Alaska fishing town of Petersburg on Mitkof Island, which still retains much of its Norwegian heritage. Explore a unique Southeast Alaska ecosystem, the muskeg, with stunted trees and carnivorous plants. There is an opportunity to stretch your legs with an optional bike ride around town. This evening, enjoy a crab feast.

Meals included: breakfast, lunch, dinner

◇ DAY 7

### Tracy Arm-Fords Terror Wilderness

Voyage into Tracy or Endicott Arm, both spectacular fjords, with waterfalls cascading from glacially carved walls. See the soaring Dawes or South Sawyer

Glacier up close and take a cruise in a Zodiac for an unbeatable view among sculpted icebergs. Keep an eye out for harbor seals, harbor porpoises and arctic terns.

Meals included: breakfast, lunch, dinner

■ DAY 8

### Juneau, Alaska / Disembark Ship

After breakfast we disembark in Juneau. Take time to visit the local shops before exploring the newly constructed Alaska State Museum, with its sprawling collection of natural history and cultural artifacts. Transfer to the airport for connecting flights home.

**Departure Time:** After 1:00 p.m. local time.

**Departure City:** Juneau

Meals included: breakfast





## ***National Geographic Quest***

---

<b>Guests</b> 100	<b>Cabins</b> 50
----------------------	---------------------

---

***National Geographic Quest*, built in 2017, is designed for sailing into fast-moving channels and shallow coves in pan-American waters.**

When she rolled out of Nichols Brothers shipyard and into the bay on Whidbey Island, the 100 guest *National Geographic Quest* became the third ship in the Lindblad fleet built at this storied Pacific Northwest shipyard. In the 1970s, Nichols Brothers built the twin ships *National Geographic Sea Bird* and *National Geographic Sea Lion*, which continue to sail the waters of the west coast of North America and Central America.

*National Geographic Quest* was purpose-built to explore the fast-moving channels and narrow straits of Alaska, along the coast of Costa Rica, and into the gray whale nursery lagoons of Baja, her design and engineering informed by our nearly 40 years of experience in these regions. Her twin boarding platforms, for example, were suggested by a veteran staffer. Enabling our team to load two Zodiacs at once means guests get off the ship quickly to take advantage of wildlife sightings and maximize exploring time.

Larger than her siblings *National Geographic Sea Bird* and *National Geographic Sea Lion*, *National Geographic Quest* has the same shallow draft, allowing her captain to navigate the same inner reaches and provide the same intimate, "insider" experiences in these charismatic regions. Modern, clean-lined, with large expanses of glass to keep you connected to the extraordinary views, *National Geographic Quest* enables you to see, do, and experience the best of her geographies.



# Cabin Categories

## Category 1

Main Deck: #301-306

Cabins feature two single beds that can convert to a Queen, a writing desk, two nightstands and two portholes, full length mirror, and reading lights.



## Category 2

Main Deck: #307-315

Cabins feature two single beds that can convert to a Queen, a writing desk, two nightstands and two portholes, full length mirror, and reading lights.



## Category 3

Upper Deck: #201-206

Cabins feature two single beds that can convert to a Queen, a writing desk, two nightstands, a large view window, full-length mirror, and reading lights.



## Category 4

Upper Deck: #207-229

Cabins feature two single beds that can convert to a Queen, a writing desk, closet, two nightstands, full-length mirror, reading lights, sliding glass door, and a small, private balcony.



**Note:** Solo occupancy cabins are available in Categories 1 and 2 only. Third person rates are available in Category 5 cabins at one half the double occupancy rate.

**Connecting Cabins via internal doorway access:**

Main Deck: #312-314, #311-315, #306-307;  
Upper Deck: #224-226, #225-227

## Category 5

### Observation Deck: #101-108 (SUITE)

Cabins feature two single beds that can convert to a Queen, large view windows, closet, two nightstands, full-length mirror, reading lights, a suite-sized expanded bathroom, writing desk, ample storage space, and a convertible sofa bed to accommodate a third person.



## Observation Deck

Category 5

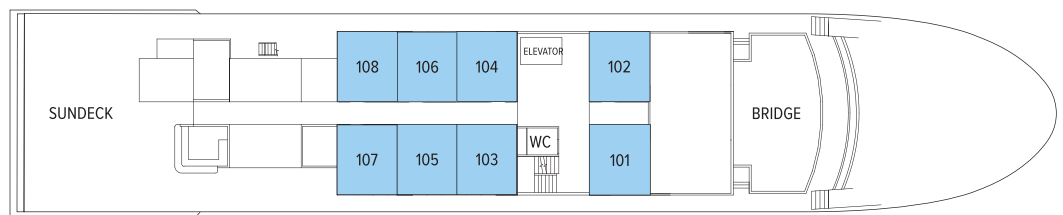

## Lounge Deck

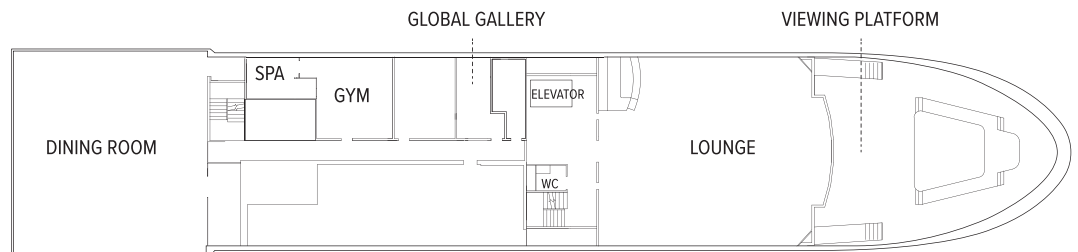

## Upper Deck

Category 3

Category 4

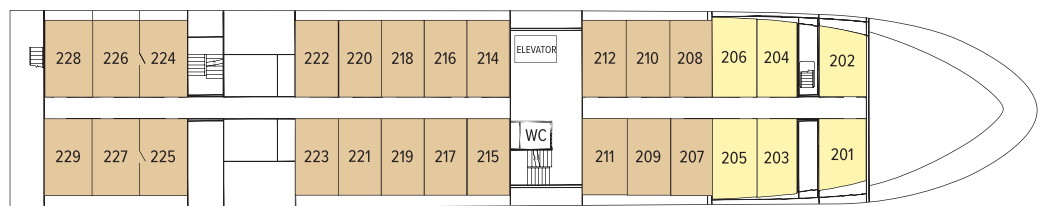

## Main Deck

Category 1

Category 2

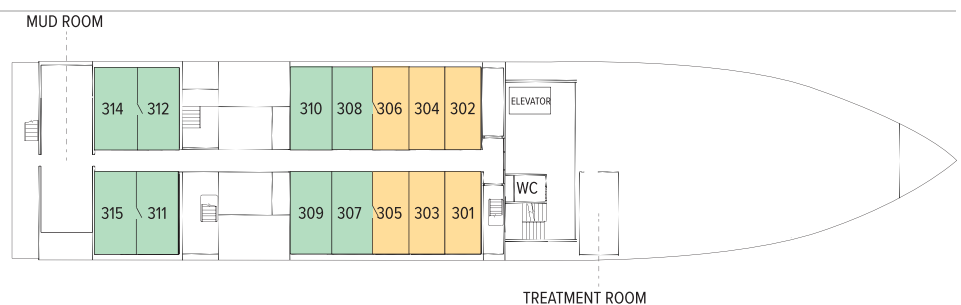



# Ship amenities

## Public Areas

Reception; main dining area; global gallery; fitness center; lounge with full-service bar and state-of-the-art presentation facilities; observation deck; mudroom with lockers for expedition gear; partially-covered furnished sundeck; plus open access to the Bridge, the Captain, officers and on-duty wildlife spotters.

## Meals

Meals are served in the dining room at a single seating with unassigned tables for an informal atmosphere and easy mingling. Menus feature sustainable choices, local where possible.

## Cabins

50 outside cabins. All cabins face outside with windows, private bathroom, and climate controls. Cabins are equipped with Wi-Fi, phone, multiple electrical and USB outlets, and phones. Luxury linens and pillows. Botanically inspired shampoo, conditioner, shower gel, and lotion are all available in cabin bathrooms, as well as an Expedition Essential Kit. Hair dryers, complimentary insulated water bottles and a National Geographic Atlas are also available in each cabin.

## Expedition Equipment

A fleet of 8 Zodiacs, 24 kayaks, paddleboards; an ROV, hydrophone, splash-cam, underwater video camera, video microscope; snorkeling gear and wet suits for all guests (where applicable).

## Special Features

Lindblad-National Geographic certified photo instructor, undersea specialist and video chronicler. Internet access. Elevator. The design of the outside decks—with the perfect wildlife viewing platform. And the way the proximity of the Lounge to the deck gives you instant access to spontaneous sightings. Have your camera ready!

## Wellness

A fitness center with elliptical, treadmill, weights, resistance bands; LEXspa treatment room, staffed by wellness specialists.



## Self-Disinfecting Ships

ACT Clean Coat™ is a light-activated, self-disinfecting cleaning process that continuously breaks down viruses, bacteria, mold, and airborne allergens across all ship surfaces. Not only does this create a cleaner, healthier shipboard environment for guests and crew alike, but this non-toxic, chemical-free system also saves more than one million gallons of water each year in our cleaning procedures, and reduces our carbon footprint as well as the amount of plastic and waste in our supply chain.

Voyage Dates	Cat. 1	Cat. 2	Cat. 3	Cat. 4	Cat. 5	Cat. 2 Solo	Cat. 3 Solo
May 25 – June 1, 2025	\$6,286	\$7,050	\$7,467	\$8,294	\$9,171	\$9,447	\$10,607

**Cost Includes:** All accommodations aboard ship; all meals as indicated in the itinerary, both aboard and onshore; beer, wine, spirits and cocktails (with super premium wines and liquors available for purchase); hors d’oeuvres, 24-hour access to snacks, premium coffees and teas, non-alcoholic beverages, and filtered water; excursions and airport transfers to and from recommended flights, as indicated in the itinerary; exploration tools such as Zodiacs and kayaks; the guidance and company of our leading expedition staff; assistance by the Lindblad Expeditions-National Geographic certified photo instructor; access to the OM System Photo Gear Locker; presentations by expedition staff; complimentary reusable water bottle; services of a medical professional; morning stretch classes and 24-hour access to the gym; 24-hour access to lounges, observation decks, library, and other shared spaces; park and site entrance fees, special access permits, and port taxes. Unused services or items included in our programs are non-refundable.

**Not included:** Airfare; pre- and post-expedition extensions; additional hotel nights (except when indicated as included); crew gratuities; private transfers; laundry, spa treatments, enhanced or premium Wi-Fi, and phone services; travel protection plans; and REAL I.D., passport, visa, or immigration fees.

**Airfare:** Airfare is an additional cost. Lindblad will assist in making your air arrangements for a \$50 per person service fee.

**Reservations:** To confirm your place, an advance payment of 15% of the cabin fare, per person is required and is payable by Visa, MasterCard, American Express, Discover, or check. Receipt of advance payment indicates your acceptance of the terms and conditions.

**Final Payment:** Payment is due 120 days prior to departure. Lindblad Expeditions reserves the right to cancel your reservation if payment has not been received by final payment due date.

**Note:** The MIT Alumni Travel Program provides further information about the Program and the relationship between the Alumni Association and the tour operator at <http://alum.mit.edu/travel/about>. The tour participant’s financial commitments are directly with the tour operator. Trip insurance is highly recommended.

**Pricing:** Prices quoted in this flyer are per person based on double occupancy in USD. Under normal conditions the total expedition price is guaranteed at the time advanced payment is made. However, our expedition pricing is determined far in advance of initial departure on the basis of then-existing projections of fuel and other costs. In the event of increases in those costs, including but not limited to increases in the price of fuel, currency fluctuations, increases in government taxes or levies, or increased security costs, we reserve the right to adjust the price of your expedition or add a surcharge to cover such unexpected increases. We will always provide an explanation of the reason for increase in costs.

**Entry and Visa Requirements:** Guests are advised to verify travel documents (passport/transit visa/entry visa) for the country(s) through which they are transiting and/or entering. Reliable and most current information regarding international travel can be found by contacting the consulate/embassy of the country(s) you are visiting or transiting through. We will not be responsible if you are denied entry or transit into a country, if you are unable to provide valid documents as per the country’s requirement.

**Responsibility and Other Terms & Conditions:** Certain other provisions concerning, among other things, limitations of Lindblad Expeditions’ and National Geographic Expeditions’ (a division of National Geographic Partners, LLC) liability for loss of property, injury, illness, or death during the voyage will be provided to all guests on the ship’s ticket sent prior to departure or upon request. By registering for a trip, the guest agrees to all such terms and conditions.

**Travel protection plan:** Travel protection and medical insurance are recommended and available at an extra cost. Information will be sent upon registration.

**Cancellation Fee Policy (Per Person)**

**120 or more days prior** to expedition start: **No penalty:** Advance Payment will be credited toward your next expedition\*\*

**119-90 days prior** to expedition start: **50% of trip cost\*\*\***

**89-0 days prior** to expedition start: **100% of trip cost\*\*\***

*\*\*Advance payments will be credited in the form of a Lindblad Expeditions Travel Certificate, valid for 12 months from the date of cancellation, and which may only be applied towards final payment on any future booking.*

*\*\*\*Trip cost is total price paid including extensions, charter airfare and other additional services.*

*We strongly recommend that you purchase a travel protection plan.*

**RESERVATION FORM:**

**MIT Alumni Travel Program**

# Exploring Alaska's Coastal Wilderness

ABOARD NATIONAL GEOGRAPHIC QUEST  
MAY 25 - JUNE 1, 2025

**To register, please contact:**

Lindblad Expeditions  
96 Morton Street  
New York, NY 10014

Ph: (833) 985-1261  
Fax: (646) 390-2050  
Email: groups@expeditions.com

**PASSENGER INFORMATION**

Please reserve \_\_\_\_ place(s)

Guest 1: \_\_\_\_\_  
*(Name as it appears on official I.D.)*

Date of Birth: \_\_\_\_\_ M/F: \_\_\_\_\_

Email: \_\_\_\_\_

Primary Phone: \_\_\_\_\_ Cell Phone: \_\_\_\_\_

Guest 2: \_\_\_\_\_  
*(Name as it appears on official I.D.)*

Date of Birth: \_\_\_\_\_ M/F: \_\_\_\_\_

Email: \_\_\_\_\_

Primary Phone: \_\_\_\_\_ Cell Phone: \_\_\_\_\_

Street Address: \_\_\_\_\_

City: \_\_\_\_\_ State: \_\_\_\_\_ ZIP: \_\_\_\_\_

- Accommodations:  Double  Single  Twin share with a friend  
 Share with roommate assigned by tour operator.

Please indicate choice of cabin category in order of preference:

1st choice: \_\_\_\_\_ 2nd choice: \_\_\_\_\_

**Advance Payment Information: 15% of the cabin fare, per person.**

- If paying by check, please make payable to: Lindblad Expeditions  
 If paying by credit card, we will contact you to finalize your booking and collect payment information.